

Rotule SI

SIL8-T-K-DURBAL - SIL8-T-K-DURBAL

<https://www.123roulement.ch/roulement-palier/rotule/si/sil8-t-k-durbal>

SIL8-T-K



female thread:
maintenance free,
according to
DIN ISO 12240-4,
series K



Description: DIN ISO rod end K series. Made of spherical plain bearing DG...PW pressed into rod end body. Sliding combination steel / bronze-PTFE composite.

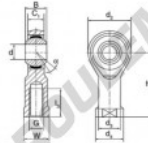

Rod end body:
surface zinc plated

Sliding combination:
steel / bronze-PTFE composite

Inner ring:
bearing steel, hardened, ground and spherical surface chromium plated

Outer ring:
brass body pressed around, outer race lined with bronze-PTFE composite

Lubrication:
maintenance free

order number		measurement [mm]						
right hand thread	left hand thread	d	G	B	C ₁	d ₂	d ₃	d ₄
SIL 8 T/K		8	M 8	12	9,00	24	12,5	16

type	measurement [mm]		h	d ₁ PT	load rating C ₁₀ [N]	weight [kg]
	l ₁ min	W				
SI / SIL 8 T/K	16	14	36	14	12,9	0,047

CARACTÉRISTIQUES PRODUIT

Marque	DURBAL
N° Ean13	3663952489155
Diam. intérieur	8 mm
Diam. extérieur	24 mm
Epaisseur	12 mm
Type	SI
Poids	47 g
Filetage	Filetage à gauche
Lubrification	sans
Conditionnement	1

contact@123roulement.ch

+33 359 36 04 90

CRT4 de Lesquin 60 Rue Du Haut De Sainghin 59273 Fretin FRANCE