

Rotule SI

SIL30M27X2-T-K-DURBAL - DSIL30M27X2-T-K-DURBAL

<https://www.123roulement.ch/roulement-palier/rotule/si/dsil30m27x2-t-k-durbal>

SIL30M27X2-T-K



female thread:
maintenance free,
according to
DIN ISO 12240-4,
series K



Description: DIN ISO rod end K series. Made of spherical plain bearing DG...PW pressed into rod end body. Sliding combination steel / bronze-PTFE composite.

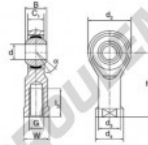

Rod end body:
surface zinc plated

Sliding combination:
steel / bronze-PTFE composite

Inner ring:
bearing steel, hardened, ground and
spherical surface chromium plated

Outer ring:
brass body pressed around, outer race
lined with bronze-PTFE composite

Lubrication:
maintenance free

order number		measurement (mm)						
right hand thread	left hand thread	d	G	B	C ₁	d ₂	d ₃	d ₄
	SIL 30 T/K M 27 x 2	30	M 27 x 2	37	25,00	70	40,0	50
type	measurement (mm)		h	d ₁	load rating C ₁₀ [N]	weight [kg]		
SI / SIL 30 T/K M 27 x 2	l ₁ min	W	h	d ₁	114,0	1,100		

CARACTÉRISTIQUES PRODUIT

Marque	DURBAL
N° Ean13	3663952489735
Diam. intérieur	30 mm
Diam. extérieur	70 mm
Epaisseur	37 mm
Type	SI
Poids	1100 g
Filetage	Filetage à gauche
Lubrification	sans
Conditionnement	1

contact@123roulement.ch

+33 359 36 04 90

CRT4 de Lesquin 60 Rue Du Haut De Sainghin 59273 Fretin FRANCE