

Rotule SA

SA40-T-K-DURBAL - SA40-T-K-DURBAL

https://www.123roulement.ch/roulement-palier/rotule/sa/sa40-t-k-durbal

SA40-T-K



male thread; maintenance free, according to DIN ISO 12240-4, series K



Description: DIN ISO rod end K series. Made of spherical plain bearing DG...PW pressed into rod end body. Sliding combination steel / bronze-PTFE composite.

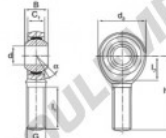

Rod end body: surface zinc plated

Sliding combination: steel / bronze-PTFE composite

Inner ring: bearing steel, hardened, ground and spherical surface chromium plated

Outer ring: brass body pressed around, outer race lined with bronze-PTFE composite

Lubrication: maintenance free

order number	measurement [mm]		C ₁	d ₂
	d	G		
SA 40 T/K	40	M 42 x 2	49	33,00

type	measurement [mm]		h	alpha [°]	Tragzahlen C ₀ [KN]	weight [kg]
	l ₁ min	l ₂				
SA / SAL 40 T/K	90	46	150	17		2,300

CARACTÉRISTIQUES PRODUIT

Marque	DURBAL
N° Ean13	3663952490458
Diam. intérieur	40 mm
Diam. extérieur	91 mm
Epaisseur	49 mm
Type	SA
Poids	2300 g
Filetage	Filetage à droite
Lubrification	sans
Conditionnement	1

contact@123roulement.ch

+33 359 36 04 90

CRT4 de Lesquin 60 Rue Du Haut De Sainghin 59273 Fretin FRANCE