

Rotule SA SA30-ES-DURBAL - SA30-ES-DURBAL

<https://www.123roulement.ch/roulement-palier/rotule/sa/sa30-es-durbal>

SA30-ES



male thread:
lubrication
is necessary,
according to
DIN ISO 12240-4,
series E

Description: DIN ISO rod end E series. Made of spherical plain bearing DGE...E (ES) pressed into rod end body. Sliding combination steel / steel. Maintenance necessary. Bore diameter $d \geq 15$ with grease nipple in rod end body and lubrication groove and hole in inner and outer ring. Bore diameter $d \geq 15$ type DSA...ES-2RS with additional seals also available.

rod end body:
surface zinc plated

Sliding combination:
steel / steel

Inner ring:
bearing steel, hardened, ground and phosphated

Outer ring:
bearing steel, hardened, ground and phosphated

Lubrication:
lubrication is necessary

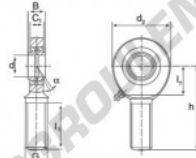

| order number | | measurement [mm] | | | | | |
|-------------------|------------------|------------------|----------|----|----------------|----------------|--|
| right hand thread | left hand thread | d | G | B | C ₁ | d ₂ | |
| SA 30 ES | | 30 | M 30 x 2 | 22 | 19,0 | 73 | |

| type | measurement [mm] | | | n [°] | load rating C ₀ [kN] | weight [kg] |
|----------------|--------------------|----------------|-----|----------|---------------------------------------|----------------|
| | l ₁ min | l ₂ | h | | | |
| SA / SAL 30 ES | 65 | 37 | 110 | 6 | 110,0 | 0,890 |

CARACTÉRISTIQUES PRODUIT

| | |
|-----------------|-------------------|
| Marque | DURBAL |
| N° Ean13 | 3663952498355 |
| Diam. intérieur | 30 mm |
| Diam. extérieur | 73 mm |
| Epaisseur | 22 mm |
| Type | SA |
| Poids | 890 g |
| Filetage | Filetage à droite |
| Lubrification | avec |
| Conditionnement | 1 |

contact@123roulement.ch

+33 359 36 04 90

CRT4 de Lesquin 60 Rue Du Haut De Sainghin 59273 Fretin FRANCE