

Rotule SA SAL40-ES-DURBAL - SAL40-ES-DURBAL

<https://www.123roulement.ch/roulement-palier/rotule/sa/sal40-es-durbal>

SAL40-ES



male thread:
lubrication
is necessary,
according to
DIN ISO 12240-4,
series E

Description: DIN ISO rod end E series. Made of spherical plain bearing DGE...E (ES) pressed into rod end body. Sliding combination steel / steel. Maintenance necessary. Bore diameter $d \geq 15$ with grease nipple in rod end body and lubrication groove and hole in inner and outer ring. Bore diameter $d \geq 15$ type DSA...ES-2RS with additional seals also available.

rod end body:
surface zinc plated

Sliding combination:
steel / steel

Inner ring:
bearing steel, hardened, ground and phosphated

Outer ring:
bearing steel, hardened, ground and phosphated

Lubrication:
lubrication is necessary

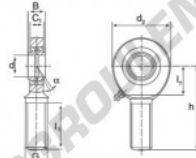

order number		measurement [mm]				
right hand thread	left hand thread	d	G	B	C ₁	d ₂
	SAL 40 ES	40	M 39 x 3	28	23,0	92

type	measurement [mm]				n [°]	load rating C ₀ [kN]	weight [kg]
	l ₁ min	l ₂	h				
SA / SAL 40 ES	86	46	150	7	180,0	1,800	

CARACTÉRISTIQUES PRODUIT

Marque	DURBAL
N° Ean13	3663952498546
Diam. intérieur	40 mm
Diam. extérieur	92 mm
Epaisseur	28 mm
Type	SA
Poids	1800 g
Filetage	Filetage à gauche
Lubrification	avec
Conditionnement	1

contact@123roulement.ch

+33 359 36 04 90

CRT4 de Lesquin 60 Rue Du Haut De Sainghin 59273 Fretin FRANCE