

Rotule TAPR

GIHR60-DO-DURBAL - GIHR60-DO-DURBAL

<https://www.123roulement.ch/roulement-palier/rotule/tapr/gihr60-do-durbal>

GIHR60-DO



Description: Hydraulic rod end. Made of spherical plain bearing DGE...ES pressed into rod end housing. Sliding combination steel / steel, with grease nipple.

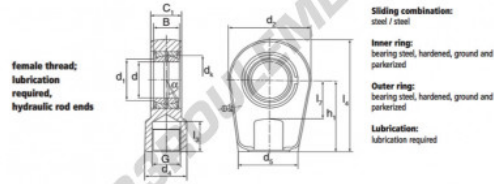

female thread:
lubrication
required,
hydraulic rod ends

Sliding combination:
steel / steel

inner ring:
bearing steel, hardened, ground and
polished

outer ring:
bearing steel, hardened, ground and
polished

Lubrication:
lubrication required

order number	right hand thread	left hand thread	measurement [mm]						
	d	d ₁	G	d ₂	d ₂	B	C ₁	d ₂	
GIHR 60 DO	60	66,8	M 58 x 1,5	75	120	44	50	130	
type	measurement [mm]				d ₁	α	load rating C ₀ [kN]	weight [kg]	
GIHR / GIHL 60 DO	l ₁ min	l ₂ min	h ₁	l ₂	66,0	6°	400	5,40	

CARACTÉRISTIQUES PRODUIT

Marque	DURBAL
N° Ean13	3663952499741
Diam. intérieur	60 mm
Diam. extérieur	130 mm
Épaisseur	50 mm
Type	TAPR
Poids	5400 g
Filetage	Filetage à droite
Lubrification	avec
Conditionnement	1

contact@123roulement.ch

+33 359 36 04 90

CRT4 de Lesquin 60 Rue Du Haut De Sainghin 59273 Fretin FRANCE