

Rotule TAPR GIHR80-DO-DURBAL - DGIHR80-DO-DURBAL

<https://www.123roulement.ch/roulement-palier/rotule/tapr/dgihhr80-do-durbal>

GIHR80-DO



Description: Hydraulic rod end. Made of spherical plain bearing DGE...ES pressed into rod end housing. Sliding combination steel / steel, with grease nipple.

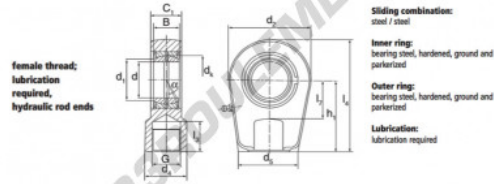

female thread:
lubrication
required,
hydraulic rod ends

Sliding combination:
steel / steel

Inner ring:
bearing steel, hardened, ground and
polished

Outer ring:
bearing steel, hardened, ground and
polished

Lubrication:
lubrication required

order number	d	d ₁	G	d ₂	B	C ₁	d ₂
GIHR 80 DO	80	80,4	M 80 x 2	105	160	55	60 176

type	l ₁ min	l ₂ min	h ₁	l ₂	d ₁	α [°]	load rating C ₀ [kN]	weight [kg]
GIHR / GIHL 80 DO	81	80	170	265,0	92,0	6	670	12,00

CARACTÉRISTIQUES PRODUIT

Marque	DURBAL
N° Ean13	3663952499819
Diam. intérieur	80 mm
Diam. extérieur	176 mm
Epaisseur	60 mm
Type	TAPR
Poids	12000 g
Filetage	Filetage à droite
Lubrification	avec
Conditionnement	1

contact@123roulement.ch

+33 359 36 04 90

CRT4 de Lesquin 60 Rue Du Haut De Sainghin 59273 Fretin FRANCE