

Rotule SA BEM05-20-501-DURBAL - BEM05-20-501-DURBAL

<https://www.123roulement.ch/roulement-palier/rotule/sa/bem05-20-501-durbal>

BEM05-20-501



male thread:
maintenance free,
adapter sizes
according to
DIN ISO 12240-4,
series K



**DURBAL® heavy-duty rod ends
with integral spherical
plain bearing**

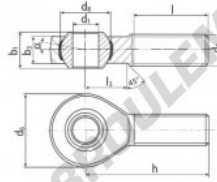

rod end housing:
forged steel, tempered, rolled thread,
surface galvanized, free of Cr-VI

joint ball:
ball bearing steel, hardened and ground,
surface superfinished and chromium
plated

race:
nylon / teflon / glass fibre compound

tolerances:
see page 10

order number		measurements [mm]			weight			basic load rating	
type	type	d ₁	d ₂	d ₃	d ₄	l ₁	l ₂	d ₅	stat.
BEM 05 -20 -501		5	M 5	18	11,06	8	6,0		
measurements [mm]		weight			basic load rating		stat.		
type	h	l	l ₃	α ₁ °	α ₂ °	[kg]	C	C ₁₀	[N]
BEM 05	33	20	9	13,0	7,5	0,014	3910	5600	[N]

CARACTÉRISTIQUES PRODUIT

Marque	DURBAL
N° Ean13	3663952507743
Diam. intérieur	5 mm
Diam. extérieur	18 mm
Épaisseur	8 mm
Type	SA
Poids	14 g
Filetage	Filetage à droite
Lubrification	sans
Conditionnement	1

contact@123roulement.ch

+33 359 36 04 90

CRT4 de Lesquin 60 Rue Du Haut De Sainghin 59273 Fretin FRANCE