

# Rotule SA BEM16-20-501-DURBAL - BEM16-20-501-DURBAL

<https://www.123roulement.ch/roulement-palier/rotule/sa/bem16-20-501-durbal>

## BEM16-20-501



male thread:  
maintenance free,  
adapter sizes  
according to  
DIN ISO 12240-4,  
series K



**DURBAL® heavy-duty rod ends  
with integral spherical  
plain bearing**

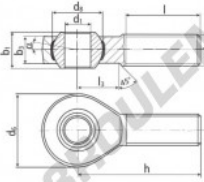

rod end housing:  
forged steel, tempered, rolled thread,  
surface galvanized, free of Cr-VI

joint ball:  
ball bearing steel, hardened and ground,  
surface superfinished and chromium  
plated

race:  
nylon / teflon / glass fibre compound

tolerances:  
see page 10

order number		measurements [mm]		weight		basic load rating	
type	type	d <sub>1</sub>	d <sub>2</sub>	d <sub>3</sub>	d <sub>4</sub>	b <sub>1</sub>	b <sub>2</sub>
BEM 16 -20 -501		16	M 16	42	28,52	21	15,0
measurements [mm]		weight		basic load rating			
type	h	l	l <sub>3</sub>	α <sub>1</sub> °	α <sub>2</sub> °	dyn. C [N]	stat. C <sub>0</sub> [N]
BEM 16	66	40	22	15,5	8,5	0,202	22410 56600

## CARACTÉRISTIQUES PRODUIT

Marque	DURBAL
N° Ean13	3616060468239
Diam. intérieur	16 mm
Diam. extérieur	42 mm
Epaisseur	21 mm
Type	GE
Poids	202 g
Filetage	Filetage à droite
Lubrification	sans
Conditionnement	1

[contact@123roulement.ch](mailto:contact@123roulement.ch)

+33 359 36 04 90

CRT4 de Lesquin 60 Rue Du Haut De Sainghin 59273 Fretin FRANCE