

Rotule SA BEM25-20-502-DURBAL - BEM25-20-502-DURBAL

<https://www.123roulement.ch/roulement-palier/rotule/sa/bem25-20-502-durbal>

BEM25-20-502



male thread:
maintenance free,
adapter sizes
according to
DIN ISO 12240-4,
series K



**DURBAL® heavy-duty rod ends
with integral spherical
plain bearing**

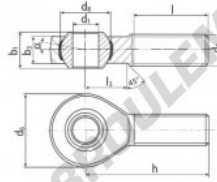

rod end housing:
forged steel, tempered, rolled thread,
surface galvanized, free of Cr-VI

joint ball:
ball bearing steel, hardened and ground,
surface superfinished and chromium
plated

race:
nylon / teflon / glass fibre compound

tolerances:
see page 10

order number		measurements [mm]		weight		basic load rating	
type	type	d ₁	d ₂	d ₃	d ₄	b ₁	b ₂
BEM 25 -20	-502	25	M 24 x 2	60	42,80	31	22,0
measurements [mm]		weight		basic load rating			
type	h	l	l ₃	α ₁ °	α ₂ °	dyn. C	stat. C ₀
BEM 25	94	57	30	15,0	10,0	[kg]	[N]

CARACTÉRISTIQUES PRODUIT

Marque	DURBAL
N° Ean13	3663952507958
Diam. intérieur	25 mm
Diam. extérieur	60 mm
Épaisseur	31 mm
Type	SA
Poids	630 g
Filetage	Filetage à gauche
Lubrification	sans
Conditionnement	1

contact@123roulement.ch

+33 359 36 04 90

CRT4 de Lesquin 60 Rue Du Haut De Sainghin 59273 Fretin FRANCE