

Rotule SA EM10-20-502-DURBAL - EM10-20-502-DURBAL

<https://www.123roulement.ch/roulement-palier/rotule/sa/em10-20-502-durbal>

EM10-20-502



male thread:
maintenance free,
adapter sizes
according to
DIN ISO 12240-4,
series E / EH



**DURBAL® heavy-duty rod ends
with integral spherical
plain bearing**

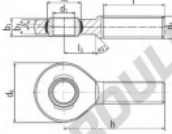

rod end housing:
forged steel, tempered, rolled thread,
surface galvanized, free of Cr VI

joint ball:
ball bearing steel, hardened and ground,
surface superfinished and chromium
plated

race:
nylon / teflon / glass fibre compound

tolerances:
see page 10

order number		measurements [mm]			weight			basic load rating	
type	type	d ₁	d ₃	d ₅	b ₁	b ₃	h	C	C ₀
EM 10	-20 -502	10	M 10	28	16,0	9	6	48	
measurements [mm]		weight		basic load rating		stat.		dyn.	
type	l	b ₃	d ₁ ^h	d ₃ ^h	[kg]	[N]	[N]	[N]	[N]
EM 10	29	15	12,0	6,0	0,041	6400	16800		

CARACTÉRISTIQUES PRODUIT

Marque	DURBAL
N° Ean13	3663952508771
Diam. intérieur	10 mm
Diam. intérieur	0.394" inch
Diam. extérieur	28 mm
Diam. extérieur	1.102" inch
Epaisseur	9 mm
Epaisseur	0.354" inch
Type	SA
Poids	41 g
Filetage	Filetage à gauche
Lubrification	sans
Conditionnement	1

contact@123roulement.ch

+33 359 36 04 90

CRT4 de Lesquin 60 Rue Du Haut De Sainghin 59273 Fretin FRANCE