

Rotule SA BEM05-60-502-DURBAL - BEM05-60-502-DURBAL

<https://www.123roulement.ch/roulement-palier/rotule/sa/bem05-60-502-durbal>

BEM05-60-502



male thread;
maintenance free,
adapter sizes
according to
DIN ISO 12240-4,
series K



**DURBAL® heavy-duty rod ends
with integral spherical
plain bearing in stainless steel**

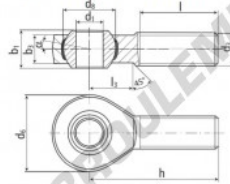

rod end housing:
stainless steel 1.4301, rolled thread,
surface with pickling treatment

joint ball:
stainless steel, hardened and ground,
surface superfinished

race:
nylon / teflon / glass fibre compound

tolerances:
see page 10

order number	type	right-hand thread	left-hand thread	d ₁	d ₂	d ₃	d ₄	h ₁	h ₂
BEM 05 -60 -502				S	M 5	18	11,06	8	6,0
measurements (mm)	type	h	l	l ₃	α ₁ ¹ [°]	α ₂ ² [°]	weight [kg]	basic load rating dyn stat. C [N] C ₀ [N]	
BEM 05		33	20	9	13,0	7,5	0,014	2400	3500

CARACTÉRISTIQUES PRODUIT

Marque	DURBAL
N° Ean13	3663952509679
Diam. intérieur	5 mm
Diam. extérieur	18 mm
Epaisseur	8 mm
Type	SA
Poids	14 g
Filetage	Filetage à gauche
Lubrification	sans
Conditionnement	1

contact@123roulement.ch

+33 359 36 04 90

CRT4 de Lesquin 60 Rue Du Haut De Sainghin 59273 Fretin FRANCE