

# Rotule SA BEM20-60-501-DURBAL - BEM20-60-501-DURBAL

<https://www.123roulement.ch/roulement-palier/rotule/sa/bem20-60-501-durbal>

## BEM20-60-501



male thread;  
maintenance free,  
adapter sizes  
according to  
DIN ISO 12240-4,  
series K



**DURBAL® heavy-duty rod ends  
with integral spherical  
plain bearing in stainless steel**

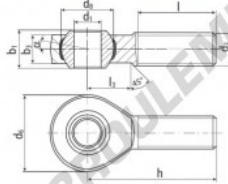

rod end housing:  
stainless steel 1.4301, rolled thread,  
surface with pickling treatment

joint ball:  
stainless steel, hardened and ground,  
surface superfinished

race:  
nylon / teflon / glass fibre compound

tolerances:  
see page 10

order number		measurements [mm]					weight		basic load rating	
type	right-hand thread	d <sub>1</sub>	d <sub>2</sub>	d <sub>3</sub>	d <sub>4</sub>	b <sub>1</sub>	b <sub>2</sub>	dyn	stat.	
BEM 20 -60	-501	20	M 20 x 1,5	50	34,87	25	18,0			
measurements [mm]		weight		basic load rating						
type	h	l	l <sub>1</sub>	α <sub>1</sub> <sup>1</sup> [°]	α <sub>2</sub> <sup>1</sup> [°]	[kg]	C	C <sub>0</sub>	C <sub>10</sub>	
BEM 20	78	47	28	14,5	9,0	0,327	18960		54800	

## CARACTÉRISTIQUES PRODUIT

Marque	DURBAL
N° Ean13	3663952509839
Diam. intérieur	20 mm
Diam. extérieur	50 mm
Epaisseur	25 mm
Type	-
Poids	327 g
Filetage	-
Lubrification	-
Conditionnement	-

[contact@123roulement.ch](mailto:contact@123roulement.ch)

+33 359 36 04 90

CRT4 de Lesquin 60 Rue Du Haut De Sainghin 59273 Fretin FRANCE