

Rotule SA BEM20-60-502-DURBAL - BEM20-60-502-DURBAL

<https://www.123roulement.ch/roulement-palier/rotule/sa/bem20-60-502-durbal>

BEM20-60-502



male thread;
maintenance free,
adapter sizes
according to
DIN ISO 12240-4,
series K



**DURBAL® heavy-duty rod ends
with integral spherical
plain bearing in stainless steel**

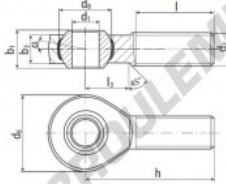

rod end housing:
stainless steel 1.4301, rolled thread,
surface with pickling treatment

joint ball:
stainless steel, hardened and ground,
surface superfinished

race:
nylon / teflon / glass fibre compound

tolerances:
see page 10

order number	type	right-hand thread	left-hand thread	d ₁	d ₂	d ₃	d ₄	l	l ₁	l ₂	h	α ₁ [°]	α ₂ [°]	weight [kg]	basic load rating dyn [N]	stat. [N]
BEM 20 -60 -502				20	M 20 x 1,5	50	34,87	25	18,0					0,327	18960	54800

CARACTÉRISTIQUES PRODUIT

Marque	DURBAL
N° Ean13	3663952509846
Diam. intérieur	20 mm
Diam. extérieur	50 mm
Epaisseur	25 mm
Type	-
Poids	327 g
Filetage	-
Lubrification	-
Conditionnement	-

contact@123roulement.ch

+33 359 36 04 90

CRT4 de Lesquin 60 Rue Du Haut De Sainghin 59273 Fretin FRANCE