

Rotule SA BEM30-60-501-DURBAL - BEM30-60-501-DURBAL

<https://www.123roulement.ch/roulement-palier/rotule/sa/bem30-60-501-durbal>

BEM30-60-501



male thread;
maintenance free,
adapter sizes
according to
DIN ISO 12240-4,
series K



**DURBAL® heavy-duty rod ends
with integral spherical
plain bearing in stainless steel**

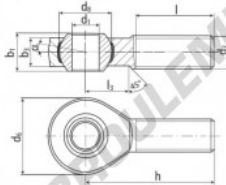

rod end housing:
stainless steel 1.4571, rolled thread,
surface with pickling treatment

joint ball:
stainless steel, hardened and ground,
surface superfinished

race:
nylon / teflon / glass fibre compound

tolerances:
see page 10

order number		measurements [mm]		measurements [mm]		weight		basic load rating	
type	right-hand thread, left-hand thread	d ₁	d ₂	d ₃	d ₄	h ₁	h ₂	C	C ₀
BEM 30 -60	-501	30	M 30 x 2	70	50,75	37	25,0		
measurements [mm]		weight		basic load rating		stat.			
type	h	l	l ₃	α ₁ [°]	α ₂ [°]	[kg]	[N]	[N]	[N]
BEM 30	110	66	35	17,0	10,5	1,015	33800	97100	

CARACTÉRISTIQUES PRODUIT

Marque	DURBAL
N° Ean13	3663952509907
Diam. intérieur	30 mm
Diam. intérieur	1.181" inch
Diam. extérieur	70 mm
Diam. extérieur	2.756" inch
Epaisseur	37 mm
Epaisseur	1.457" inch
Type	SA
Poids	1015 g
Filetage	Filetage à droite
Lubrification	sans
Conditionnement	1

contact@123roulement.ch

+33 359 36 04 90

CRT4 de Lesquin 60 Rue Du Haut De Sainghin 59273 Fretin FRANCE